

Indian HFG Standard Components

Room Layout Sheet

Room Name **Clerical Support/ Medical Records**

RLS Room Code **CLREC-IN**
RDS Room Code **CLREC-IN**

- AS ADJUSTABLE SHELF
- COM/2 COMMUNICATIONS OUTLET - DOUBLE
- GPO/2 GENERAL PURPOSE OUTLET-DOUBLE
- LS/P LIGHT SWITCH - PELMET TASK LIGHT
- LS/R LIGHT SWITCH - ROOM
- OP OBSERVATION PANEL
- SK4 FLOOR VINYL COVERED SKIRTING
- SK5 FEATHER EDGE VINYL SKIRTING
- V1 FLOOR VINYL STANDARD
- WB WHITEBOARD

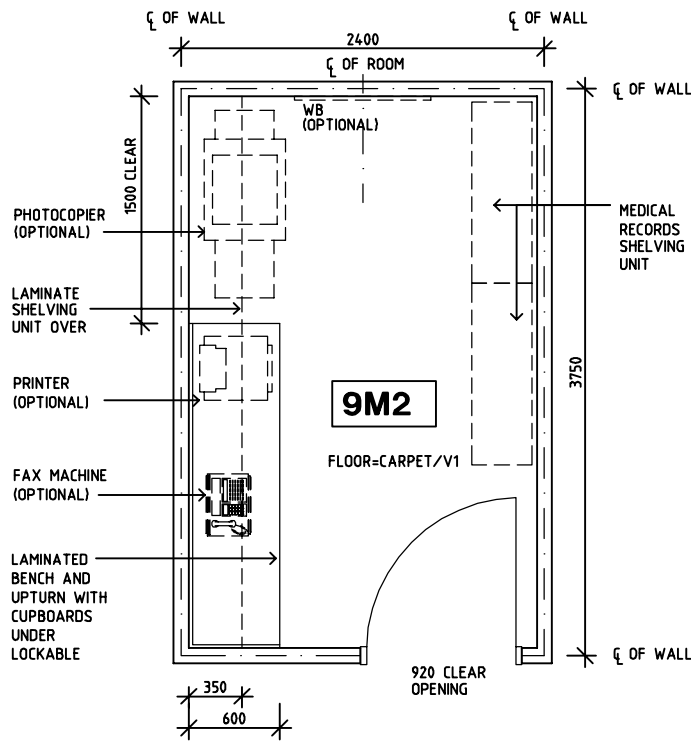

PLAN

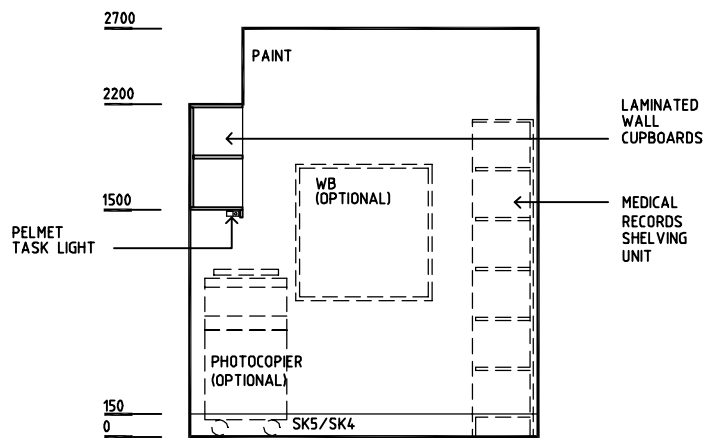

ELEVATION 1

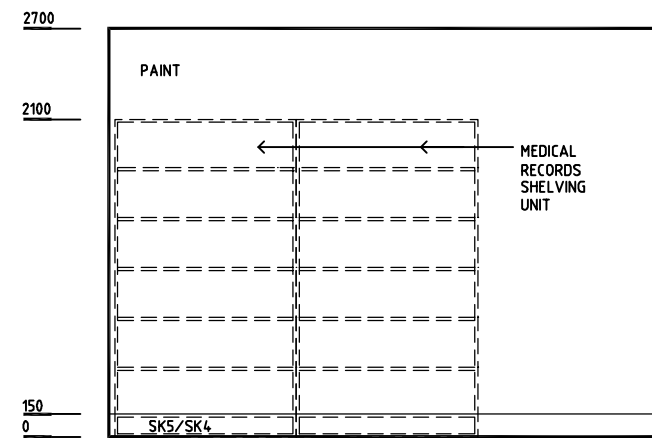

ELEVATION 2

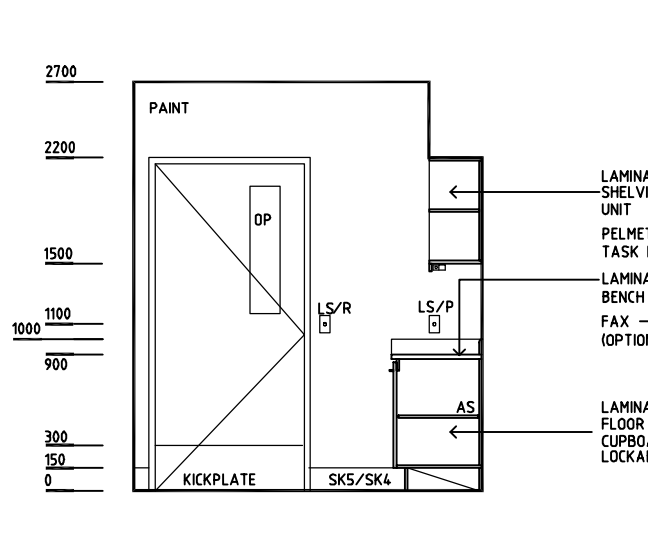

ELEVATION 3

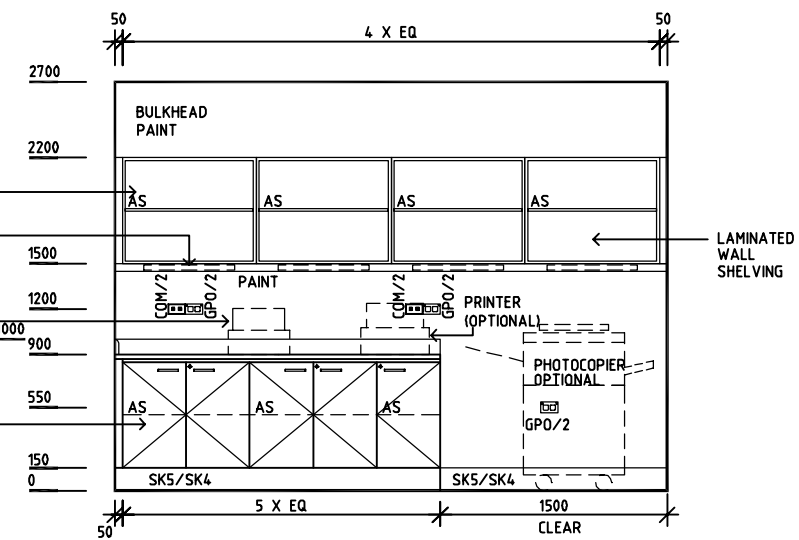

ELEVATION 4

REV	DESCRIPTION	DATE	BY	REV	DESCRIPTION	DATE	BY	REV	DESCRIPTION	DATE	BY
1	FIRST ISSUE	24.02.2014	AA								

<p>Indian Health Facility Guidelines</p>	<small>Indian Health Facility Guidelines at: www.healthdesign.com.au/ihfg Editable version of Standard Components on Health Facility Briefing System (HFBS) at: www.healthdesign.com.au Provided by TAHPI</small>				DESIGNED	APPROVED	DATE	SCALE(S)	SHEET
	CC	DB	24.10.10	1:50 in A3	1 of 1				
	CAD FILE NAME CLREC-IN		PAPER DRAWING ID CLREC-IN		ISSUE 1				

Department	Indian Health Facility Guidelines	Room Tag:	1940
Room Name	Medical Records	Room Code:	CLREC-IN
Net Room Area Briefed	9.0 M2		
No of Rooms	1		
Subtotal of Briefed Area	9.00 M2		
Hours of Operation	8am to 8pm, Monday to Friday		
Occupancy	1-2 intermittently		
Also covers these Rooms			
Description/ Special Requirements	A room for clerical activities including record sorting and secure storage of medical records. The photocopier, facsimile and printer may also be located in this area if required.		
Amendment	05.03.2014 - Issue 1		

Room Fabric and outline specifications

ID	Fabric	Material	Finish	Specification	Selection	Remarks
5060	Ceiling	Acoustic	Prefinished	Drop-in tiles, 600x1200		
6025	Cornice	Aluminium	Powdercoat	shadow line		
8000	Door protection	Vinyl	Prefinished	Kickplate, 300mm high		
9004	Doors	Solid Core/ Glass	Paint	Single leaf, observation panel		920mm clear opening, lockable
1149	Floor finish	Carpet	90/10 Wool/ Nylon	Broadloom, 48 oz.		vinyl also acceptable
949496	Skirting	Timber	Paint	150mmH x 20mm thick, nominal		or floor vinyl covered skirting
3000	Wall finish	Paint	Acrylic, washable			

Fittings and Furniture (FF)

ID	Description	Category	Group	Qty	Selection / Remarks
1050	Bench: laminate	Furniture/ Fitting	1	1	
4420	Cupboard: under bench, lockable	Furniture/ Fitting	1	1	adjustable shelves; paper storage
13661	Metal shelving: medical records	Furniture/ Fitting	3	2	
20000	Shelving unit: adjustable	Furniture/ Fitting	1	1	over bench
24400	Whiteboard	Furniture/ Fitting	2	1	900 x 900, optional

Fixtures, Equipment and associated Services (FE)

ID	Description	Group	Qty	Ele	Data	CdW	HtW	WmW	Tap	Dns	Gas	Selection / Remarks
20800	Facsimile machine	3	1	yes	yes	___	___	___	___	___	___	optional
39800	Photocopier	3	1	yes	___	___	___	___	___	___	___	optional
41100	Printer: networked	3	1	yes	yes	___	___	___	___	___	___	optional

Services

ID	Description	Service Category	Qty	Selection / Remarks
1006	Voice / Data outlet: double	Communications	3	1 outlet for telephone-fax

Department Indian Health Facility Guidelines
 Room Name Medical Records

Room Tag: 1940
 Room Code: CLREC-IN

ID	Description	Service Category	Qty	Selection / Remarks
5000	Airconditioning	HVAC		
5019	Exhaust	HVAC		over photocopier
6000	General fluorescent	Lighting		
9001	GPO: Double	Power	3	